

# AI SHANG SPORTS APP

User Manual V3.0

## 1. App Introduction

The "AI SHANG Sports" app is a mobile application that complements the "SHANG Sports Camera." It provides support for sports scenarios, including device management, device networking, video preview, field calibration, live streaming and recording, game scoring, and event recording management. The Android version is now available on Tencent's App Store platform. We sincerely invite you to download and experience it.

## 2. App Download and Installation

Currently, the app supports Android 10.0 and above.

1. Search and download the "AI Sports" app on Tencent App Store to complete the app installation.



Download APP from App Store

2. AI SHANG Sports App Operation Videos: Scan the QR code below to follow our video channel for viewing.



Follow the video public account

### 3. APP Operation

#### 1.Add Device

Before adding a device, ensure Bluetooth and Wi-Fi are enabled on your phone and allow the AI SHANG Sports app to access your location information..

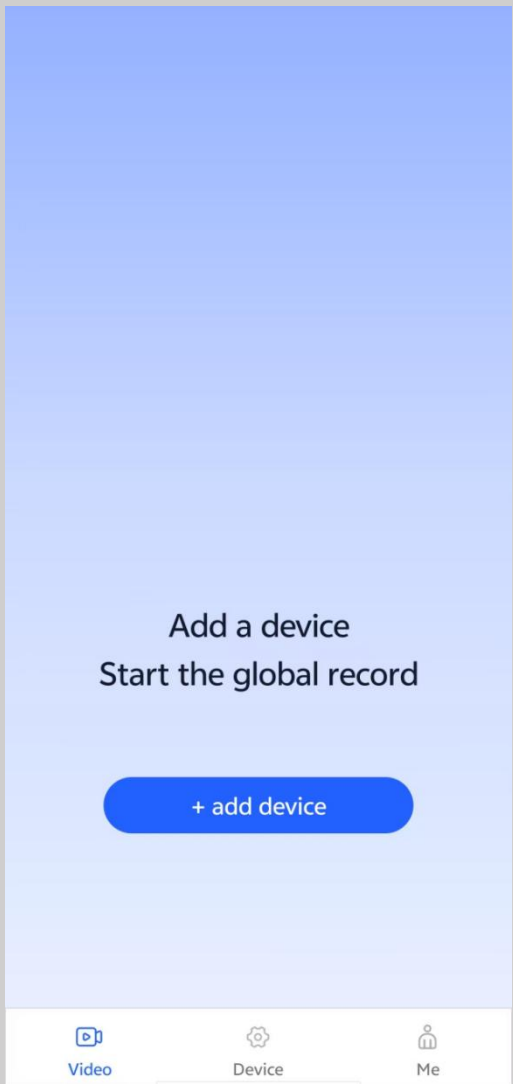
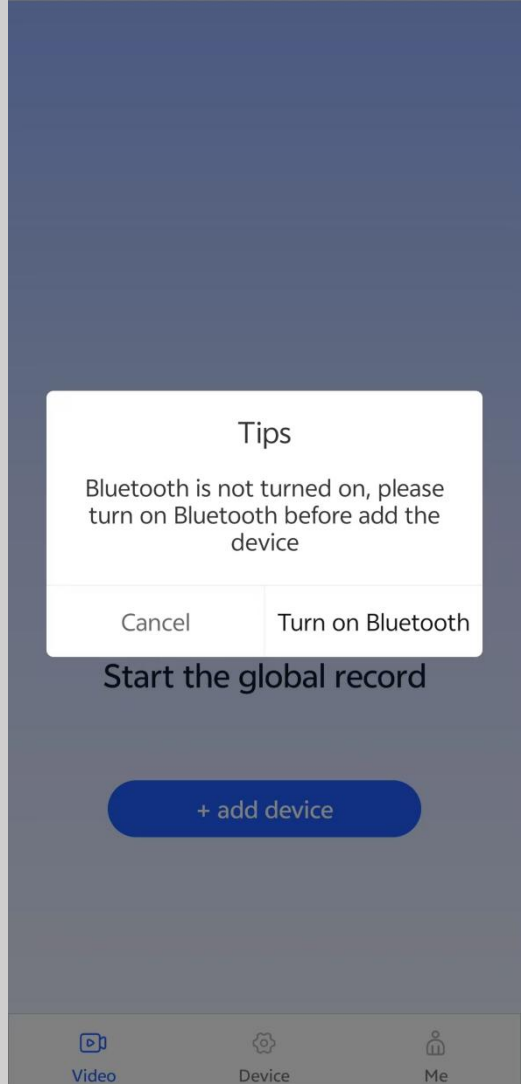
<p>1) Login to APP, click “add device” in the main interface.</p>	<p>2) Bluetooth is not enabled on your phone. Follow the prompts to enable Bluetooth and select the option to turn it on.</p>
	

3) If the phone is not WIFI enabled, the app will issue a guide to turn on WIFI.

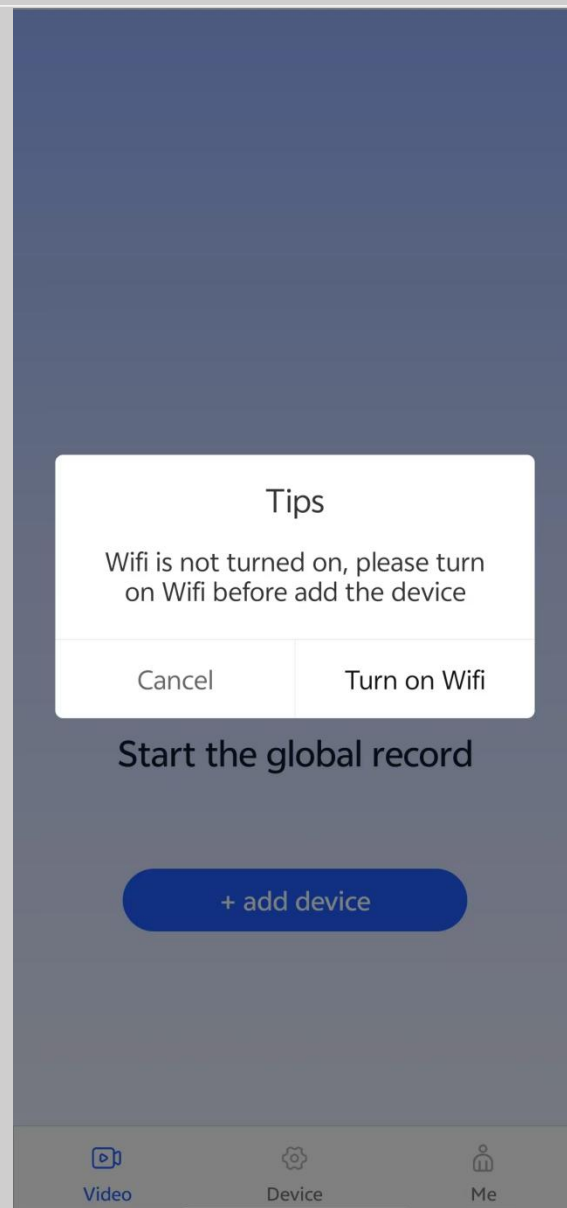

4) After turning on WIFI and Bluetooth, you can search for nearby devices.

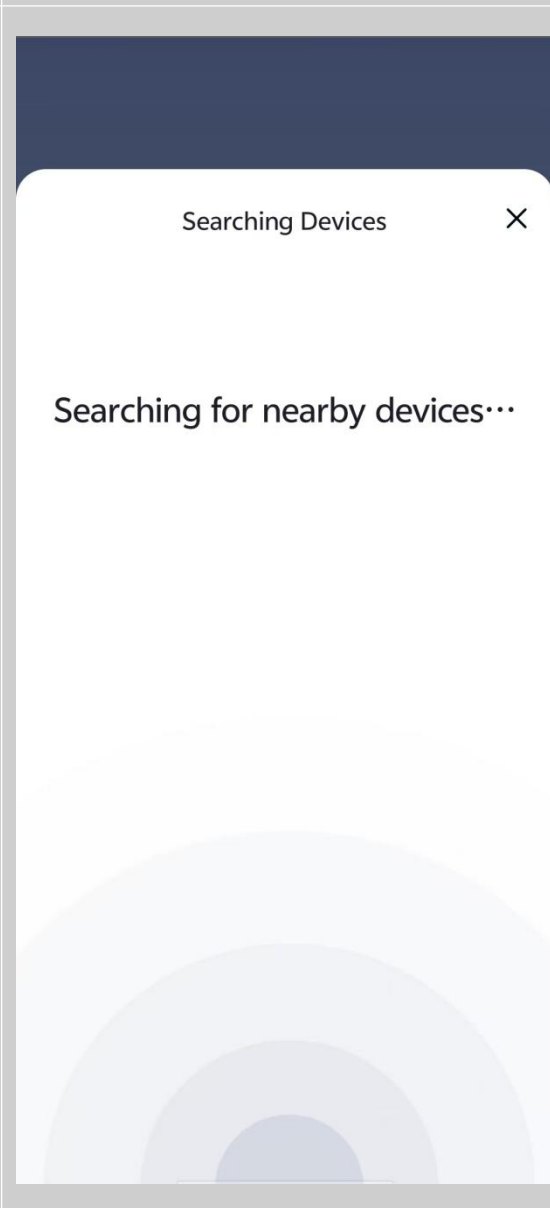

5) Search the list of nearby devices, Select the device in "My Devices" to connect..

6) When connecting, the app will pop up the WIFI hot-spot that comes with the device, click "Connect" to successfully connect to the device.

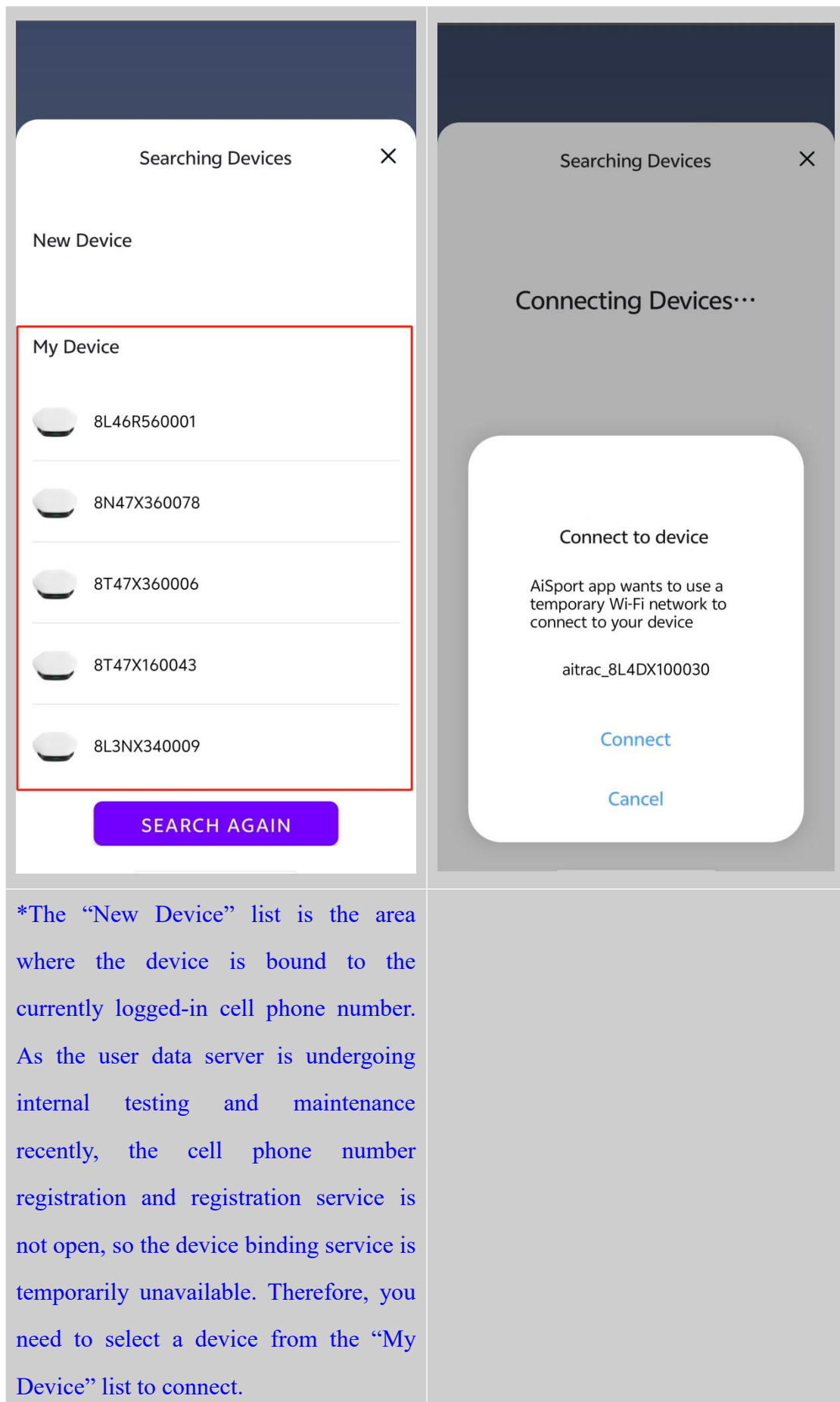

## 2.Screen Preview

1) Normal device preview, with device information displayed above: device name, sport type (basketball/soccer, etc.), serial number, available recording time, remaining battery life, storage capacity, etc.

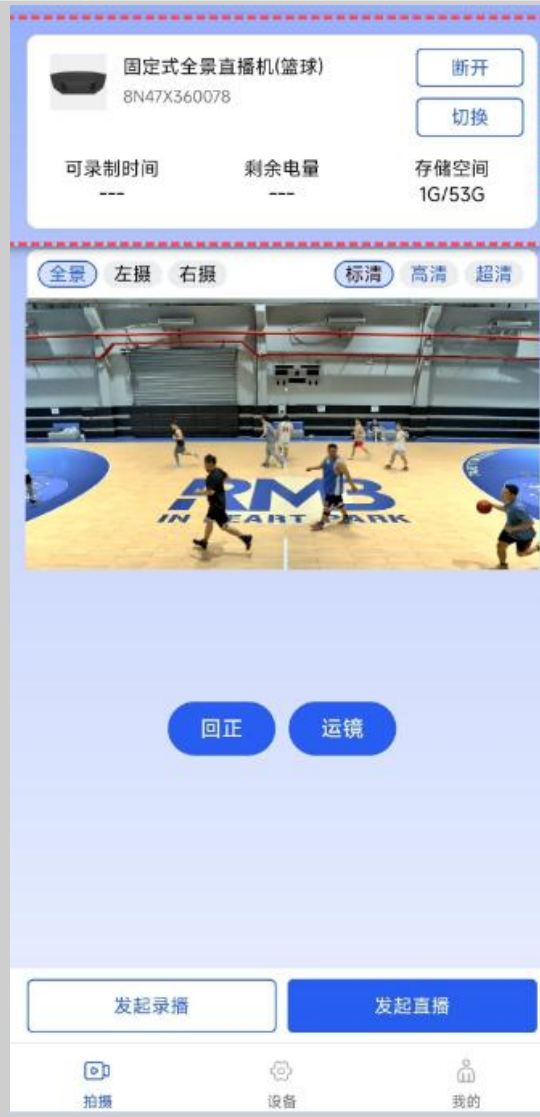

2) Switch between standard definition, high definition, and ultra-high definition video quality. Supports selection between tracking and centered display modes: (Tracking: Enabled by default, automatically follows the action with dynamic camera movement) (Centered: Displays the central shooting area without camera movement)



3) For basketball version: You can choose between panoramic, left-shot, and right-shot preview modes for the video. In left/right modes, you can turn on/off the automatic generation of goal recognition video clips (half-court basket calibration is required).



4) For the football version: No left or right camera preview mode, goal recognition is enabled by default to generate short video clips (goal calibration is required)



### 3.Device Networking

The device supports WIFI, wired, and 4G networking (optional). To

initiate the live streaming, the device must be connected to the Internet in advance. Scheduled recording can be performed without an internet connection. (4G networking does not support hot-swapping 4G SIM cards. The device must be powered off before inserting a SIM card.)

<p>1) Click “Device” below to enter the configuration interface, select “Network” to enter the network configuration interface.</p>	<p>2) Display the current device network status. Select the desired network connection method. Once the device successfully connects to the network, it will display “Connected” and assign an IP address (4G connections do not have an IP address)</p>
	



## 4. Site Calibration

In order to adapt to the sports venue, the scene needs to be calibrated before use. The accuracy of the venue calibration will affect the accuracy of the camera tracking recording. Different sports venues support different calibrations.

1) Click “Device” below to enter the configuration interface, select “Algorithm Calibration” to proceed with site calibration operations; choose a site for calibration.	2) Basketball Edition Camera: Supports full-court calibration (for camera movement) and left/right hoop calibration (for highlight capture); Soccer Edition Camera: Supports full-field calibration (for camera movement) and goalpost calibration (for highlight capture).
--	--

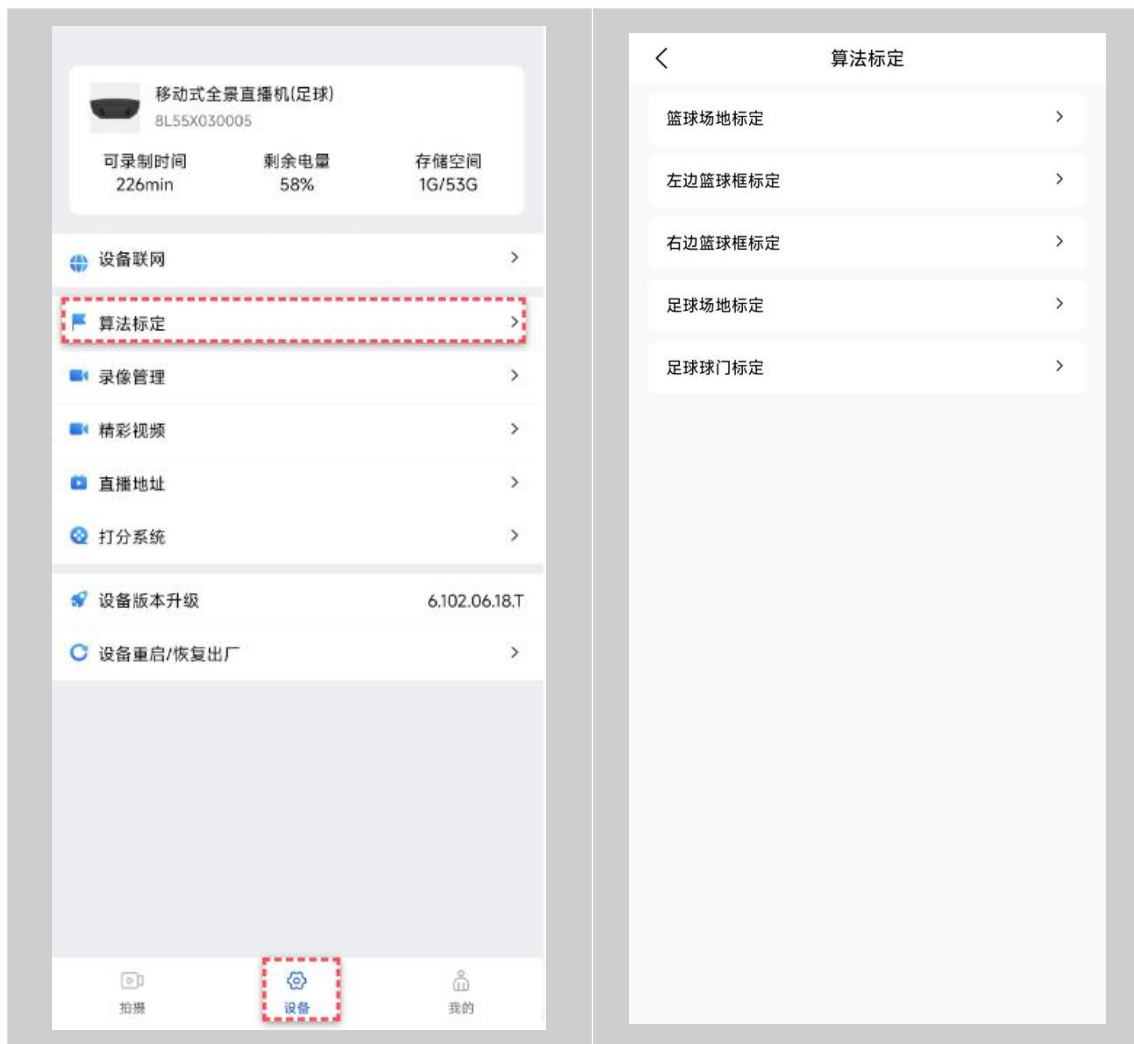

3) Basketball Court Calibration: Adjust the camera angle to capture the entire court without distortion, aligning the vertical calibration reference line as closely as possible with the court's center line. Drag the four calibration points to align with the court's four corners. A magnifying glass on the right aids in precise calibration. Complete calibration.



4) Left and Right Basket Calibration: Drag the orange box to the basket position and adjust its width and height using the buttons on the right. Ensure the basket is fully contained within the box with the best possible fit to complete calibration.

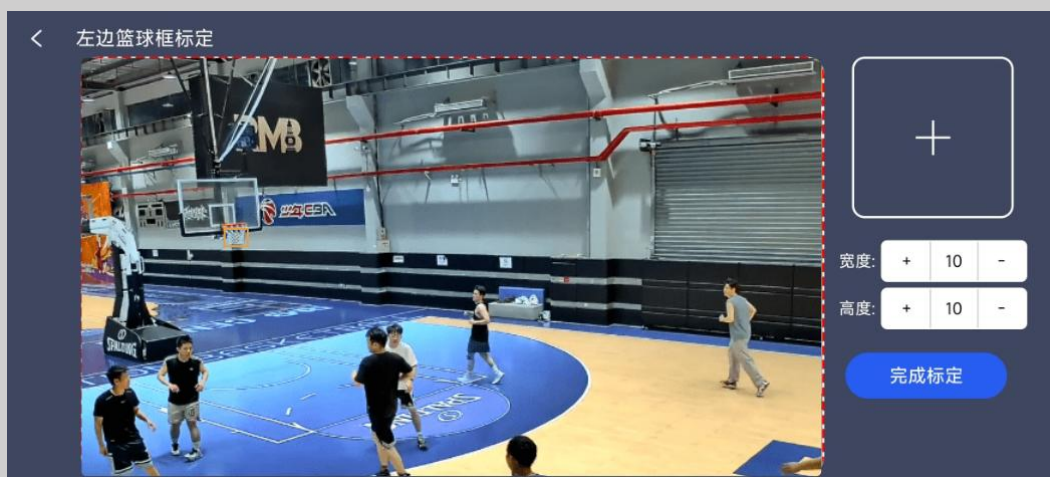

5) Football Field Calibration: Adjust the camera angle to capture the entire field without tilting, aligning the vertical calibration reference line with the center line as closely as possible. Drag the four calibration points to calibrate the four corners of the field. A magnifying glass on the right side facilitates calibration accuracy. You also need to select the field type: Standard Field (11-a-side), Midfield Field (7-8-a-side), or Small Field (5-6-a-side). Calibration is complete.



6) Football goal calibration: Drag the two orange boxes to the two football goal positions respectively, and adjust the width and height of the boxes using the buttons on the right to make sure the football goals are completely contained within the boxes and fit as closely as possible to complete the calibration.



## 5. Live Streaming Address

Currently, the APP supports RTMP streaming to third-party live streaming platforms. Before launching a live streaming, you must first obtain the live streaming platform's live streaming address and fill it in.

(Note: The method of obtaining the RTMP address varies from platform to platform. Some platforms require certain permissions, such as Video

Account and Bilibili. Some platforms cannot obtain the streaming address, such as Tiktok and Kuaishou. Please understand the platform's RTMP streaming address acquisition requirements in detail).

1) Click “Device” below to enter the configuration interface, select “Live Address” to fill in the live address.

2) Select the corresponding live streaming area—choose between Full Field, Left Half, or Right Half streaming (Football Edition only supports Full Field streaming). Combine the streaming address and streaming secret key into one field and save.

The image shows two screenshots from a mobile application. The left screenshot displays a menu with options: 全景摄像机 (PTGHVGVJGCGVJGC), 设备联网, 算法标定, 录像视频, 直播地址 (highlighted with a red box), 打分系统, 设备版本升级, and 设备重启/恢复出厂. The bottom navigation bar has icons for 拍摄, 设备 (highlighted with a red box), and 我的. The right screenshot shows the '直播地址' (Live Address) configuration page. It has three sections: '全景推流地址' (Full Field Streaming Address) with a text input containing a long RTMP URL and '保存' (Save) button; '左摄推流地址' (Left Camera Streaming Address) with a text input and '保存' button; and '右摄推流地址' (Right Camera Streaming Address) with a text input and '保存' button. A black toast message '保存成功' (Save Success) is displayed in the center.

6. Launching Live Streaming

1) On the main interface, select the live screen display mode, then select the return to center or tracking mode, and finally start the live streaming.



(2) After the live streaming push is successful, open the live streaming in the third-party live streaming platform, you can watch the stadium live streaming screen in the third-party live streaming platform.



7. Initiate recording

After initiating a recording, the game video is saved to the device's local memory.

1) On the main interface, select the recording display mode, then choose to

2) Recording display shows recording in progress and recording timer.



enable the return-to-center or tracking mode, and finally initiate the recording.



## 8. Score Stacking

1) Click “Device” below to enter the configuration interface, select “Scoring System” to enter the scoring interface.

2) Enter team information prior to the start of the game, and later manually enter scores based on the scoring of the ball game.

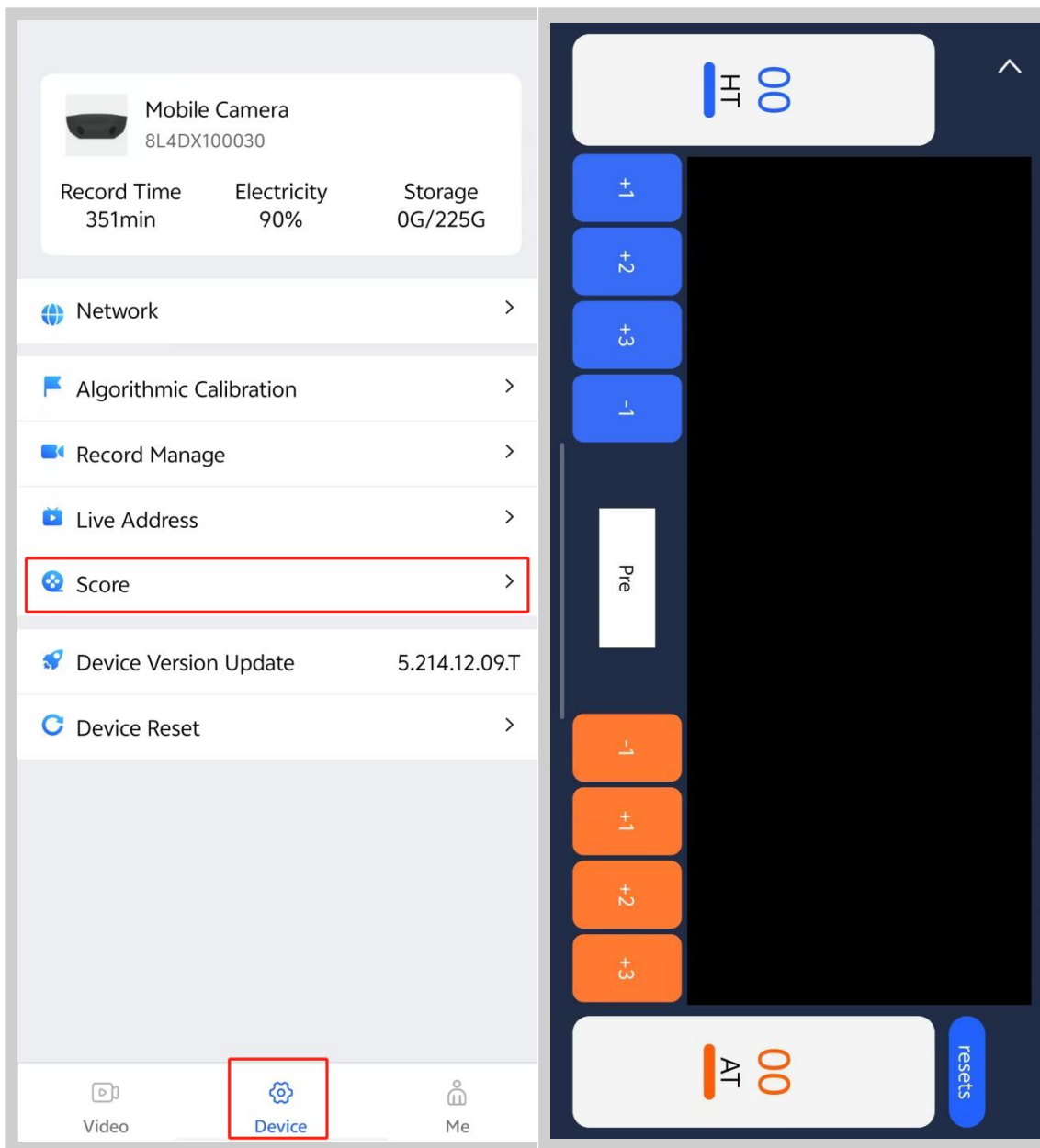

## 9. End of live/recorded stream

1) If the device is live streaming, in the APP preview interface, click “live” and select “Stop Live”.

2) If the device is recording, in the APP preview interface, click “Record” and select “Stop Record”.



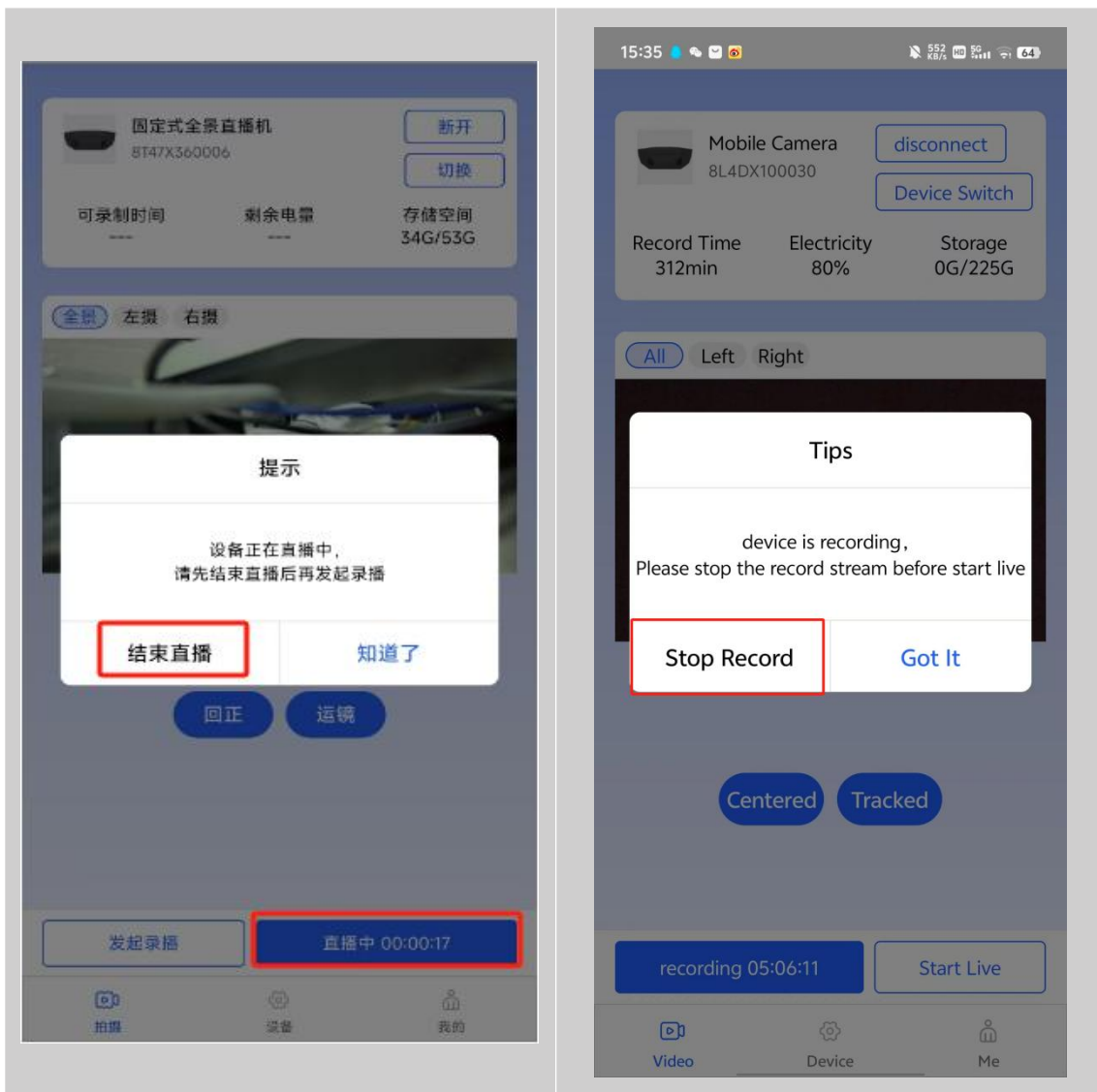

Note: If the operation fails, please check whether the phone is connected to the device WIIF hots-pot, if not connected, please reconnect the device search.

## 10. Video Viewing

After recording a video, the footage is stored on the device's local memory card and can be viewed, downloaded, or deleted.

1) Click on the bottom of the “device”, select “record management” to enter.

2) Recorded videos will appear in the video list. Select a video from the list and click to play it back.



3) Tap the edit button in the video list to choose whether to download the video to your phone or delete it.



## 11. Highlight

After enabling AI-generated highlights, the system will automatically create goal highlight videos whenever a goal is scored during a match. These videos can be viewed, downloaded, or deleted.

1) Click “Devices” below, then select “Highlight” to enter.

2) Select the date to view highlights.  
After clicking Edit, you can download or delete videos.

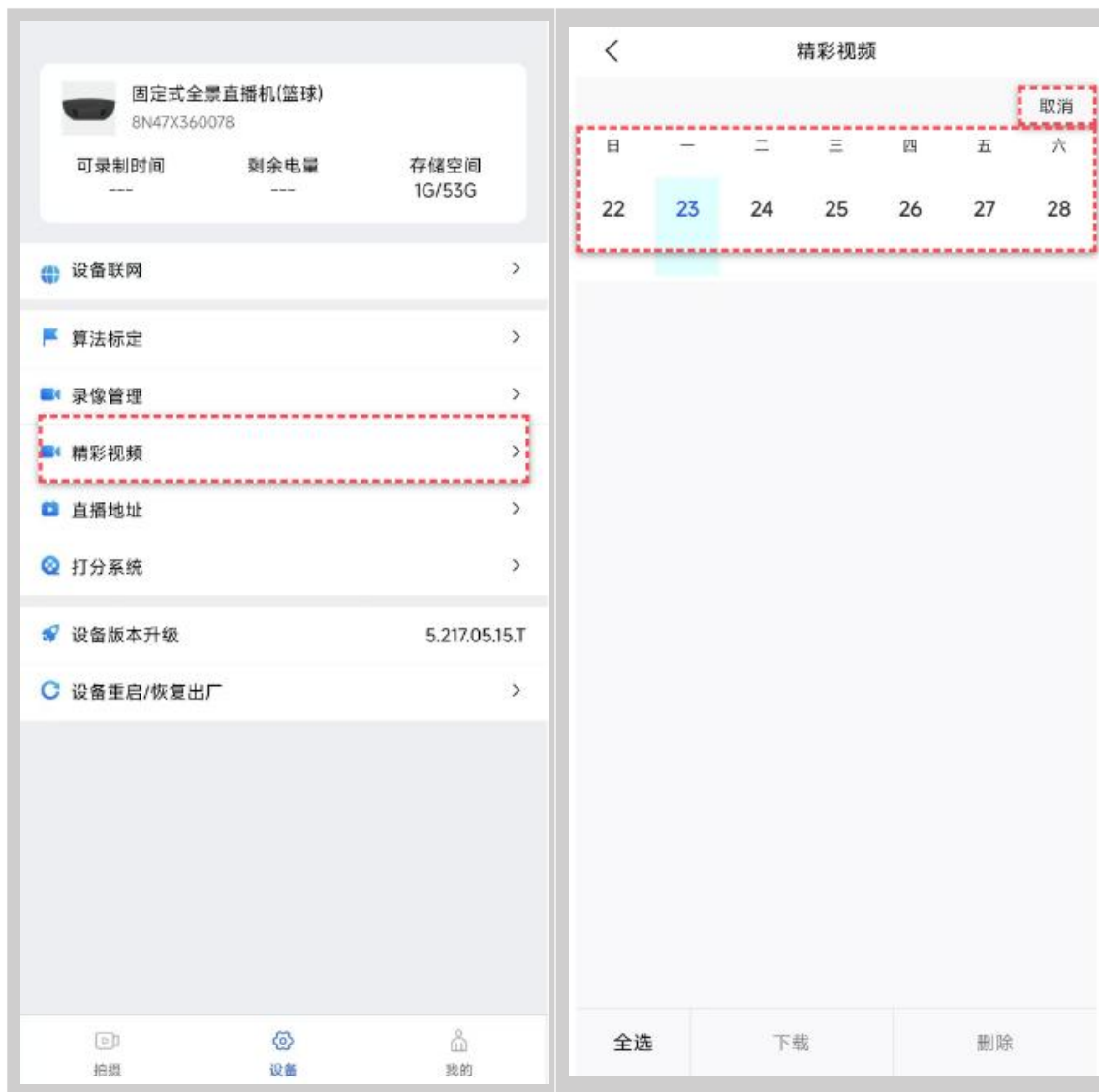

## 12. Additional Functionality

The app allows users to view connected device version information, perform device restart, and execute factory reset operations.

1) View device version information in the “Device” section; Access “Device Restart/Factory Reset” to remotely restart the device or restore factory settings.

2) You can view the app version number in the “My” section.

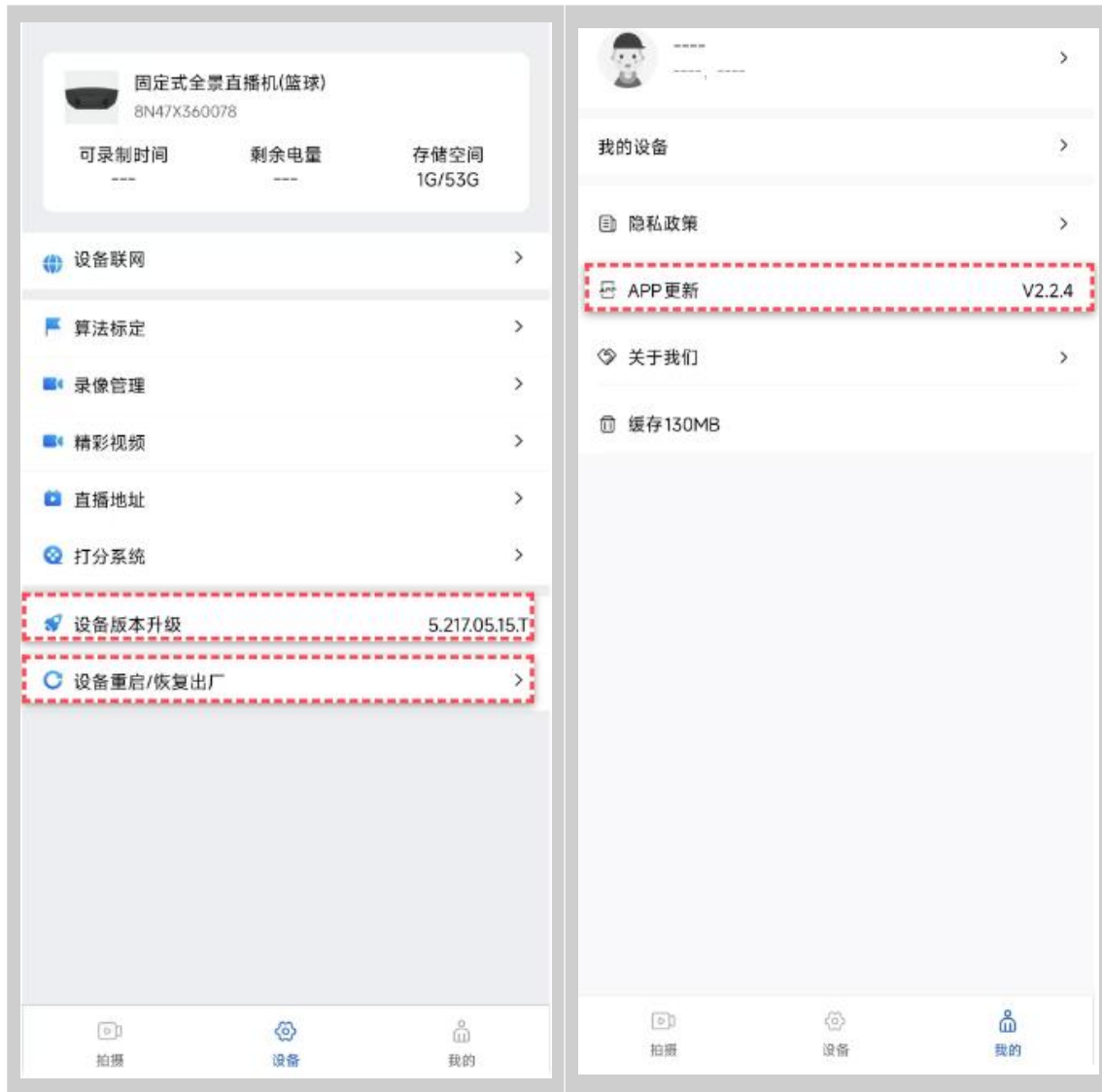

## Attention

1. APP and camera connection need to open the phone Bluetooth, WIFI, and location permissions.
2. If the app requires device configuration, it must remain connected to the device.
3. If not connected, please reconnect the camera, if you do not need to configure the camera can be disconnected.
4. After APP configures the camera successfully, the camera will get an

IP address.

5. To avoid unstable connection between APP and camera due to cell phone battery policy, it is recommended to set background lock for “AI SHANG Sports” APP on the cell phone (different cell phones have different methods of locking APP, please refer to the actual cell phone operation).

For video operation guides, please follow Raying Technology's official video account.



Experience the AI SHANG Sports Camera app in action—follow the AI SHANG Sports TikTok account:

